

# SWE 434

# Software Testing and Validation

---

*Lecture slides are available on following website through your university student login*

<https://lms.ksu.edu.sa/>

**Raja Majid Mehmood**

[rmehmood@ksu.edu.sa](mailto:rmehmood@ksu.edu.sa)

Department of Software Engineering,  
King Saud University, Riyadh, Saudi Arabia.

# Importing the Java Project

- Right click on package explorer
  - Click on **import**

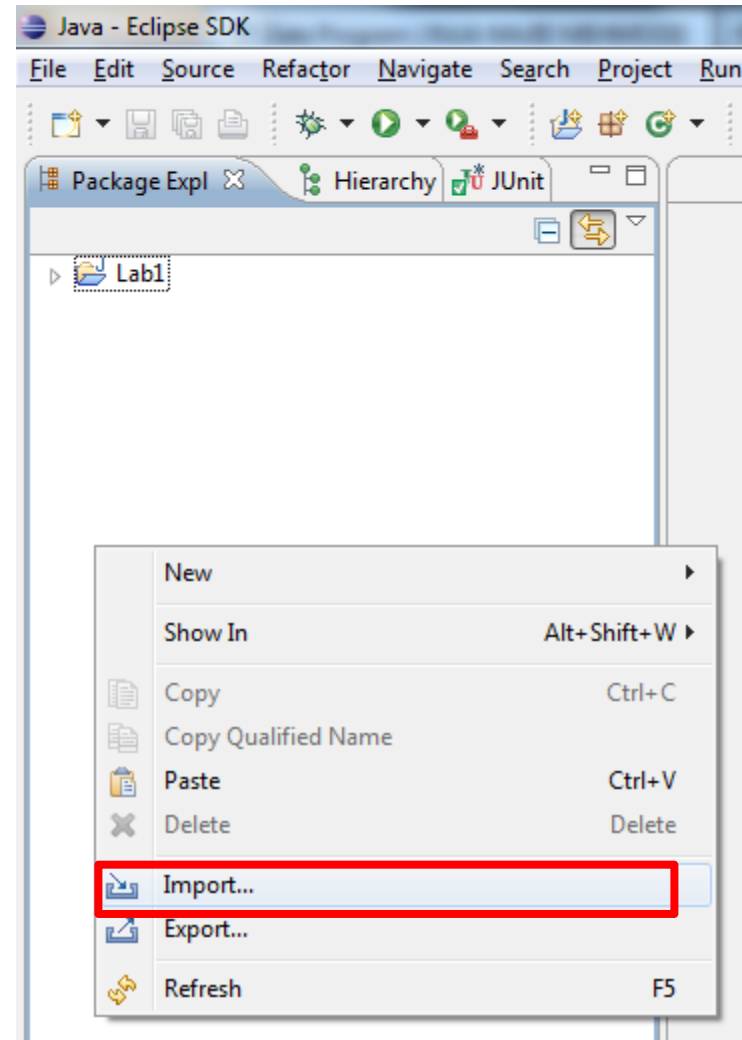

# Importing the Java Project

- Choose Existing Projects...
  - Click on **Next**

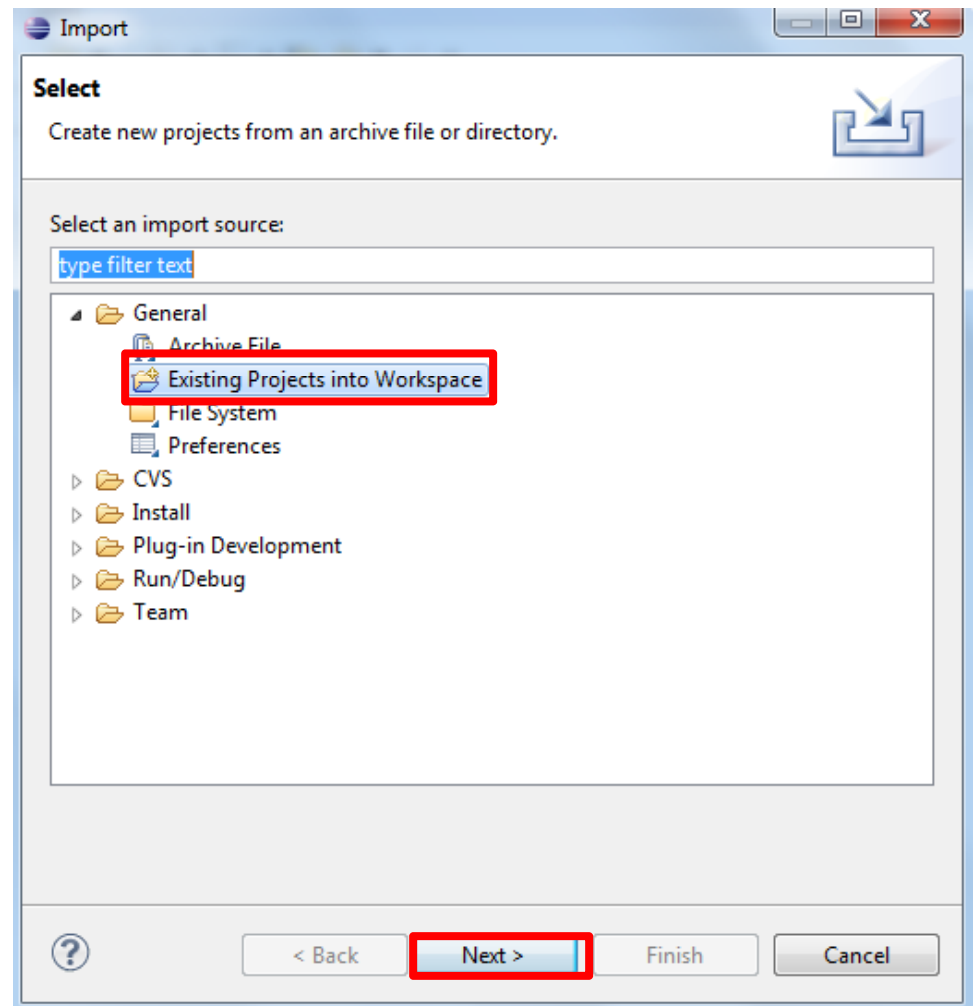

# Importing the Java Project

- Choose **Browse**

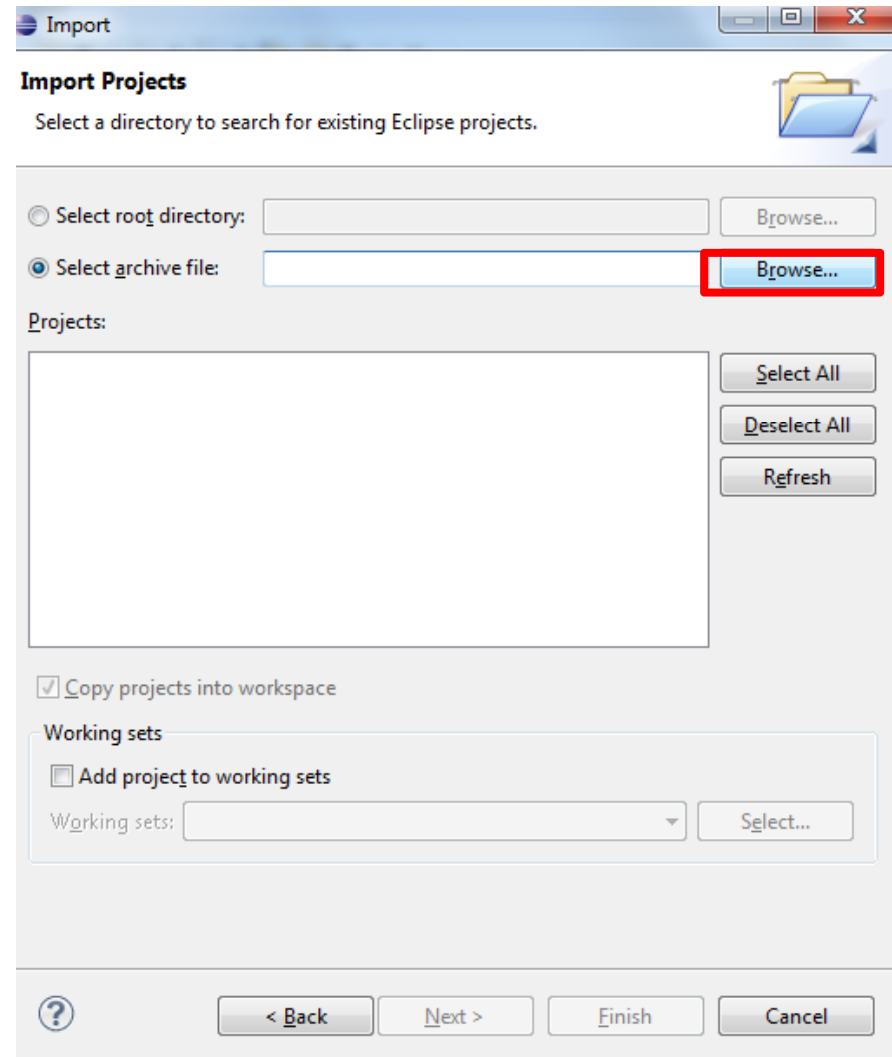

# Importing the Java Project

- Enter any *URL* or *Project Source Location*
  - For example;
    - **\\A\PRJ\Lab2**

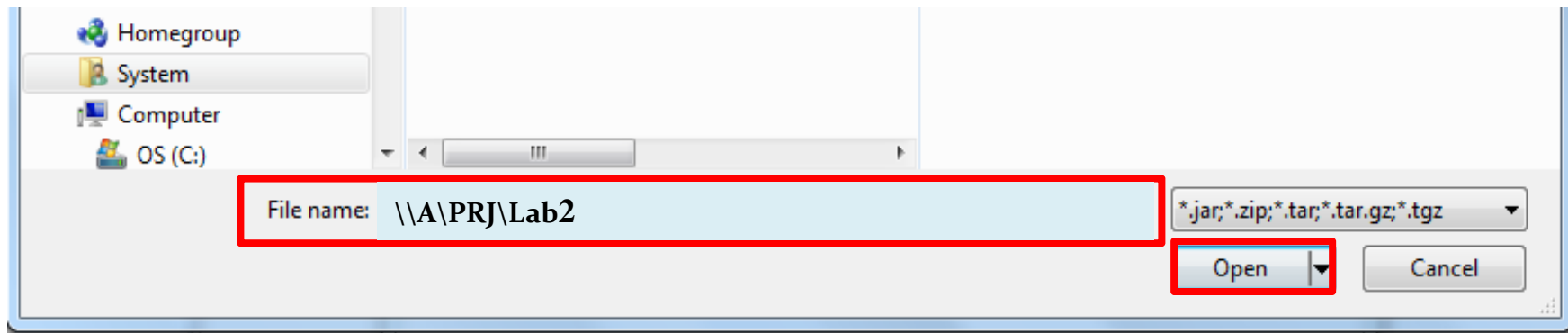

- Click on **Open**

# Importing the Java Project

- Select Lab2
  - Click on **Finish**

